

## Montagehinweise „Freestyle WALL“ Regalsystem

Var. 1: H = 2000mm

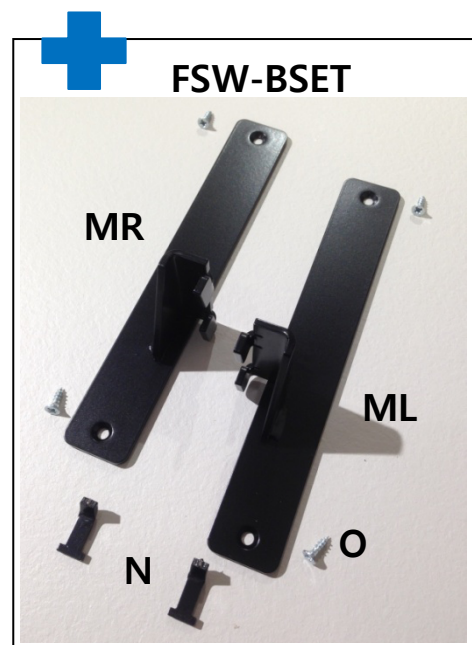

Var. 2: H = 1100mm

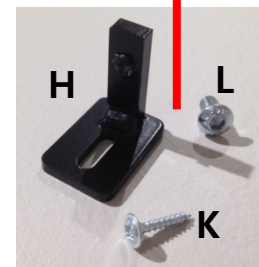
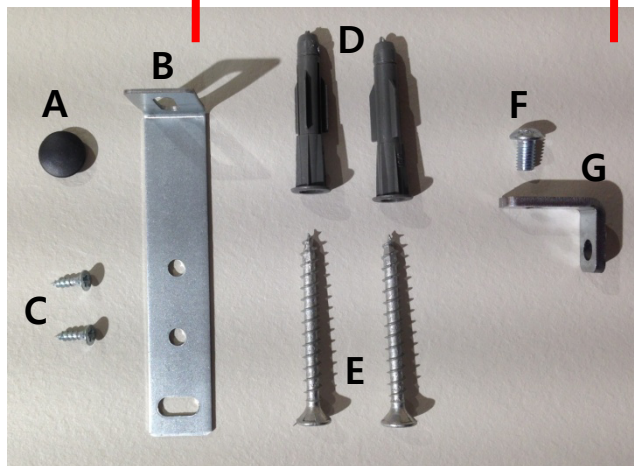

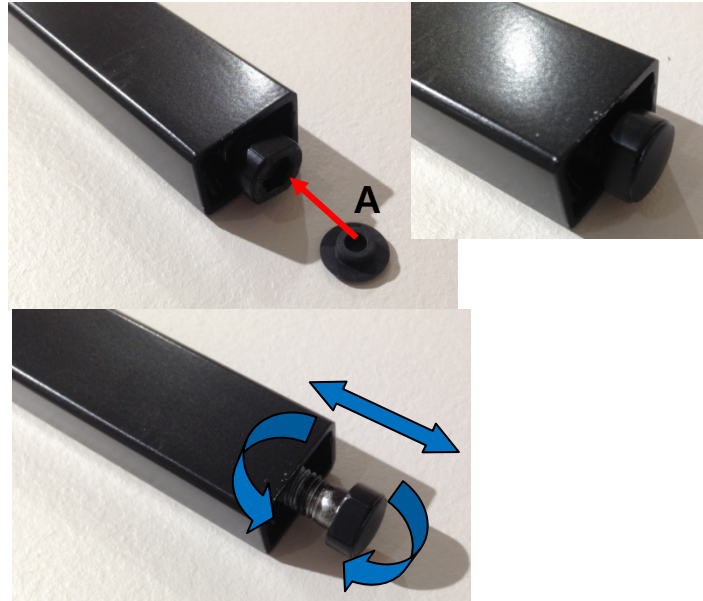

**X = Fachbreite**  
**Bodenmaß oder Breite Schrank**

 Schrankbreite bei Einsatz  
von seitlichen Wangen größer!

**1** Var. 1 + Var. 2: Befestigung OBEN

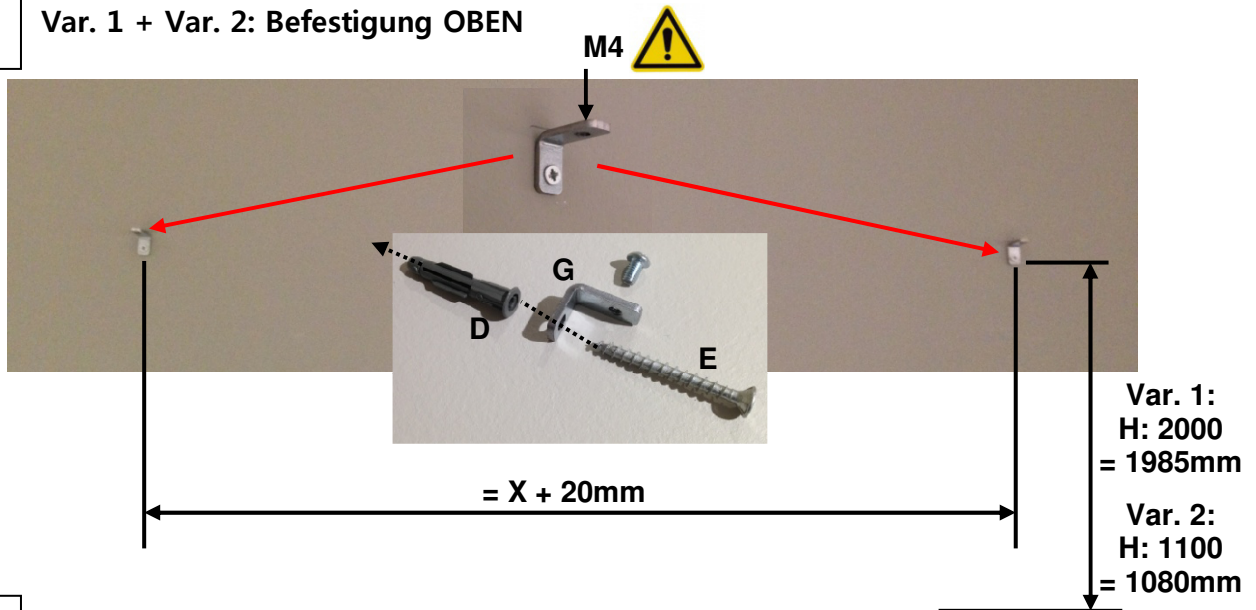

**2** Var. 2 → Befestigung UNTEN

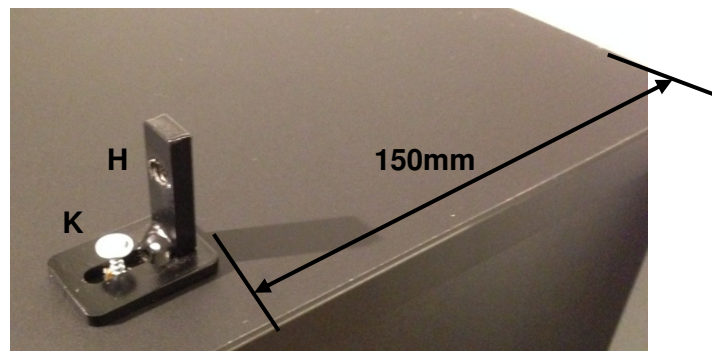

**3** Stollen setzen und befestigen  
Var. 1

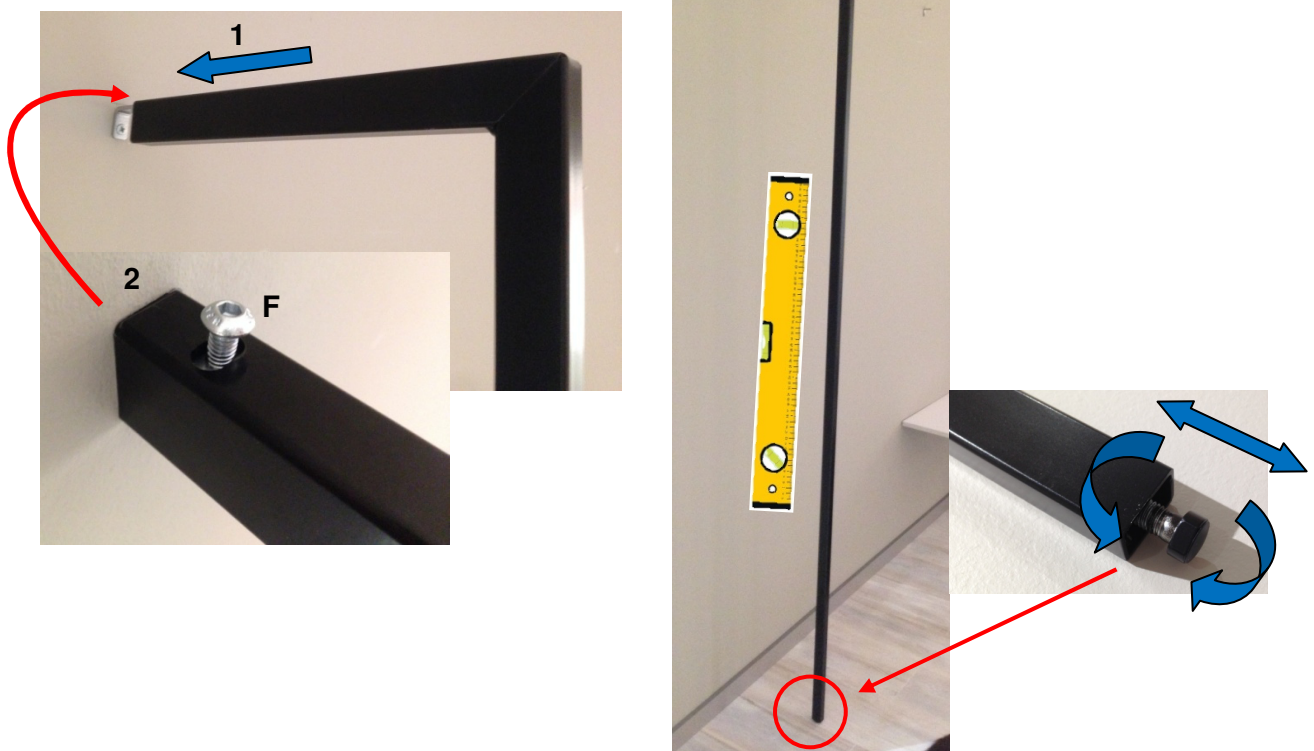

**3** Var. 2

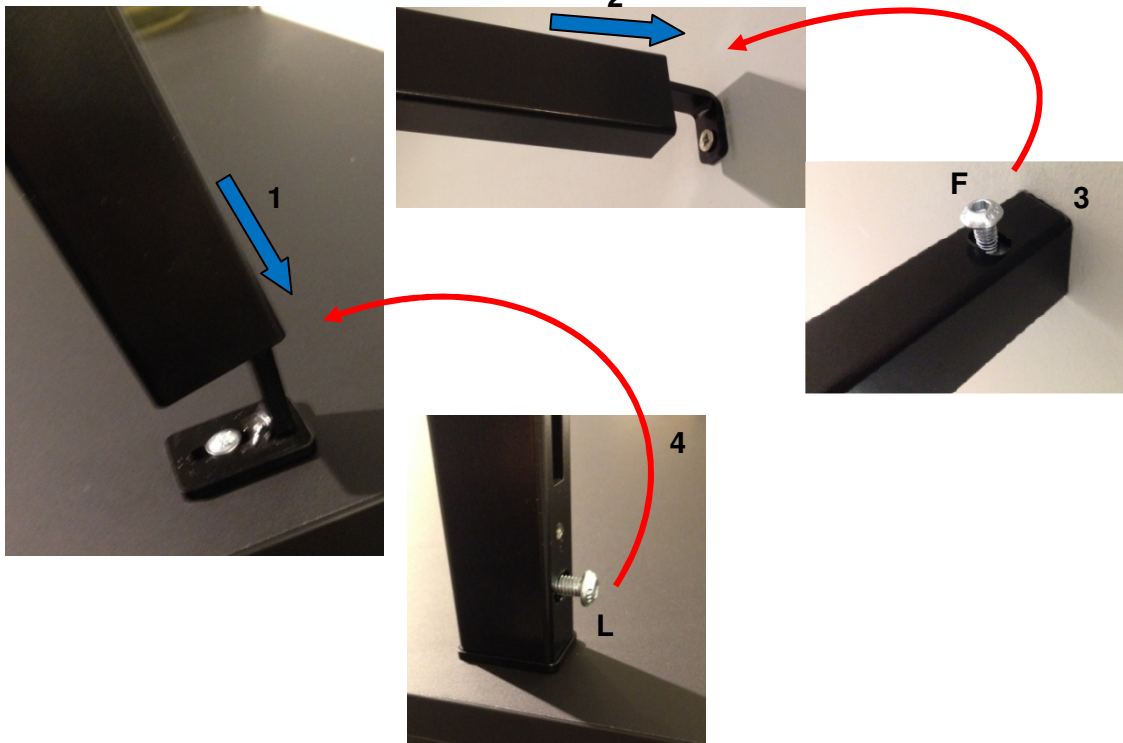

**4** Elemente einhängen (Bodenträger, Kleiderstange, Nischenreling)



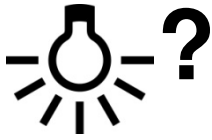

FSW-LEDP110  
FSW-LEDP200



**5**

**Böden einbauen**

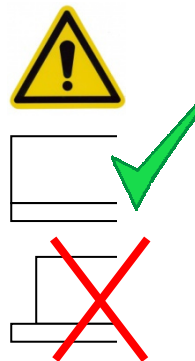
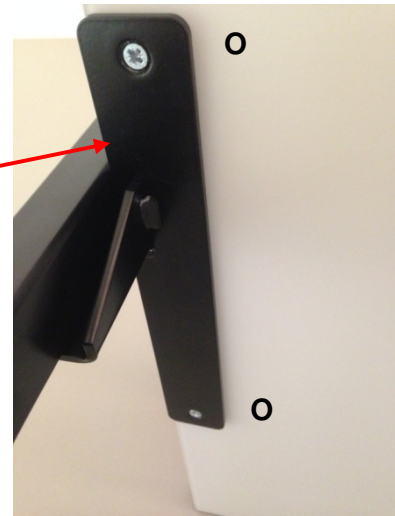

**6** Var. 1: Befestigung unten

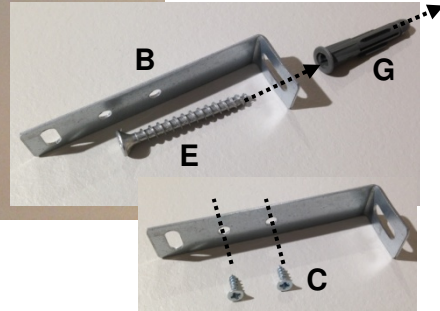
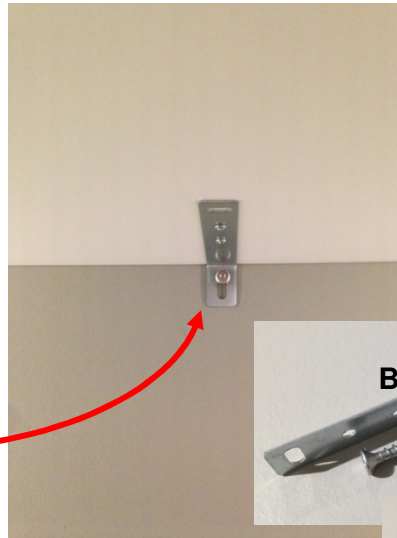

**7** Var. 1 + 2: Aushebesicherung einsetzen

